



Helix *by* CORNDELL

Why buy Helix?

Helix is superbly crafted from European oak solids and veneers, manufactured in the UK and has a choice of four great finishes.

Helix offers a range of flexible modular storage and audio visual solutions to create a modern look for your home.



The 'IT IS Great British Furniture' is an initiative designed to increase awareness of the key factors that make British made furniture great in the eyes of the consumer, retailers, contract specifiers, architects and the wider international audience, and we at Corndell are very proud to be included as manufacturers of Great British Furniture.

Versatility

The collection includes floor standing and wall hanging pieces that perfectly complement each other and provide practical storage and a fresh look for your living space. The design features include 'floating' tops, internal lighting to glazed pieces and metal bar handles. All glass shelves and glazed doors are made from toughened glass. Each base section has a removable wooden shelf.

Variety

The four durable lacquered finishes, Mist, Satin, Chestnut and Dark are smooth to the touch and have a subtle sheen.

Durability

Helix is handmade from oak, which has always been the favourite wood of UK furniture manufacturers because of its strength, durability and beauty.



Linear styling



Stylish metal handles



Internal LED lighting



Floating style solid oak tops

Finishes

Four attractive finishes are available for this furniture.

To order your chosen finish, please prefix the model code with the appropriate finish prefix. For example an H102 in Mist finish should be ordered as HM102.

Please note: Individual products in this brochure are photographed in the Mist finish.

Mist

A pale durable lacquer is applied to the wood. The finish is smooth to the touch and has a gentle sheen.

Satin

A golden durable lacquer is applied to the wood. The finish is smooth to the touch and has a gentle sheen.

Chestnut

A durable, smooth to the touch, rich chestnut silky lacquer.

Dark

A dark stain is applied to the wood to give the rich dark colour then the satin lacquer is applied to seal the colour and give protection and a sheen to the surface.

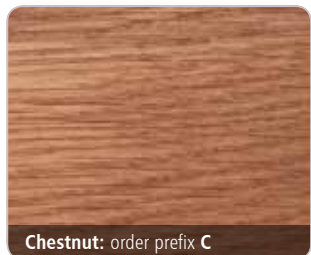

Helix *by* CORNDELL



Wall Mounted Units Supplied with adjustable wall mounting brackets

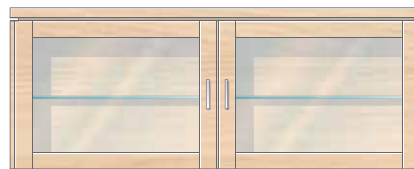

**Glazed 2 Door/1 Shelf
Wall Unit H240**
Internal light.
One adjustable glass shelf.
H490 x W1035 x D285mm
H19¼ x W40¾ x D11¼ inches

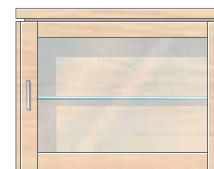

**Glazed 1 Door/1 Shelf
Wall Unit**
H140R Hinged on right (shown)
H140L Hinged on left
Internal light.
One adjustable glass shelf.
H490 x W520 x D285mm
H19¼ x W20½ x D11¼ inches

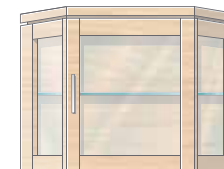

Glazed Corner Wall Unit
H143R Hinged on right (shown)
H143L Hinged on left
Internal light.
One adjustable glass shelf.
H490 x W520 x D485mm
H19¼ x W20½ x D19 inches
Length along wall from
corner 540mm – 21¼ inches

143

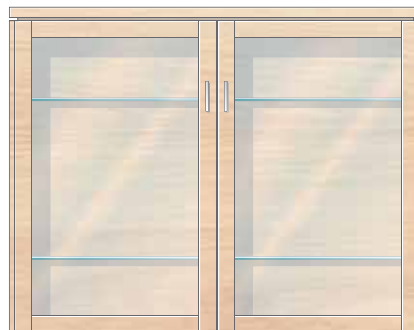

**Glazed 2 Door/2 Shelf
Wall Unit H241**
Internal light.
Two adjustable glass shelves.
H950 x W1035 x D285mm
H37½ x W40¾ x D11¼ inches

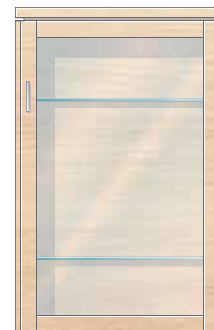

**Glazed 1 Door/2 Shelf
Wall Unit**
H141R Hinged on right (shown)
H141L Hinged on left
Internal light. Two adjustable
glass shelves.
H950 x W520 x D285mm
H37½ x W20½ x D11¼ inches

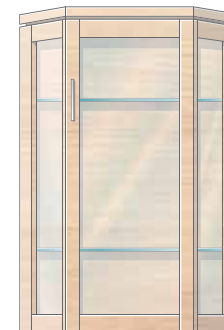

Glazed Tall Corner Wall Unit
H142R Hinged on right (shown)
H142L Hinged on left
Internal light.
Two adjustable glass shelves.
H950 x W520 x D485mm
H37½ x W20½ x D19 inches
Length along wall from
corner 540mm – 21¼ inches

142

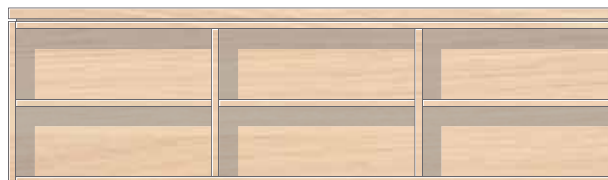

Triple Open Wall Unit H341
H490 x W1555 x D285mm
H19¼ x W61¼ x D11¼ inches



Double Open Wall Unit H242
H490 x W1035 x D285mm
H19¼ x W40¾ x D11¼ inches

Base Units

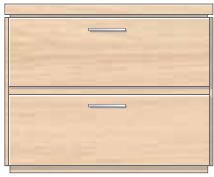

2 Drawer Base Unit H102
H510 x W520 x D430mm
H20 x W20½ x D17 inches



1 Door Base Unit
H104R Hinged on right (shown)
H104L Hinged on left
H510 x W520 x D430mm
H20 x W20½ x D17 inches

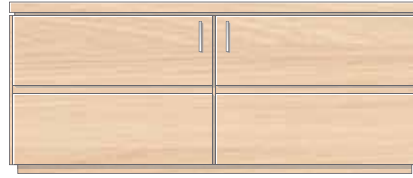

2 Door Base Unit H212
H510 x W1035 x D430mm
H20 x W40¾ x D17 inches

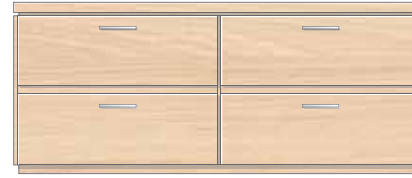

4 Drawer Base Unit H213
H510 x W1035 x D430mm
H20 x W40¾ x D17 inches

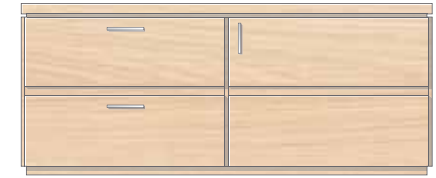

2 Drawer/1 Door Base Unit H214
H510 x W1035 x D430mm
H20 x W40¾ x D17 inches

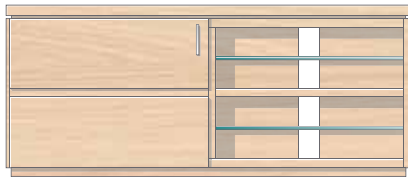

1 Door Open Media Base Unit H210
One central fixed wooden shelf and two removable glass shelves in glazed section.
H510 x W1035 x D430mm
H20 x W40¾ x D17 inches

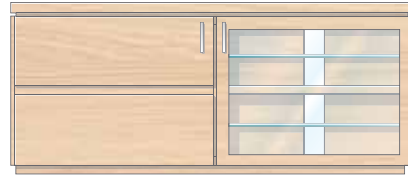

Glazed 2 Door Media Base Unit H211
One central fixed wooden shelf and two removable glass shelves in glazed section.
H510 x W1035 x D430mm
H20 x W40¾ x D17 inches

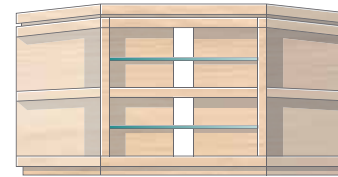

Open Corner Base Unit H402
One central fixed wooden shelf and two removable glass shelves.
One removable wooden shelf in each side section.
H510 x W800 x D770mm
H20 x W31½ x D30¼ inches
Length along wall from corner 800mm – 31½ inches

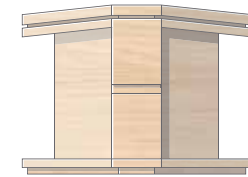
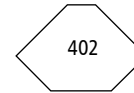

Corner Base Fill In H401
H510 x W555 x D555mm
H20 x W21¾ x D21¾ inches
Length along wall from corner 560mm – 22 inches

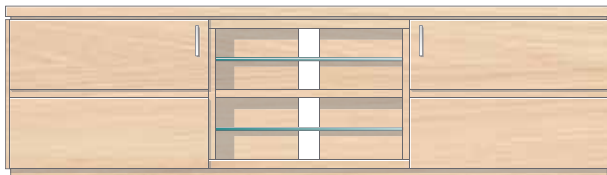
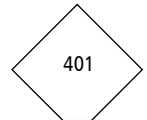

2 Door Open Media Base Unit H321
One central fixed wooden shelf and two removable glass shelves in glazed section.
H510 x W1555 x D430mm
H20 x W61¼ x D17 inches

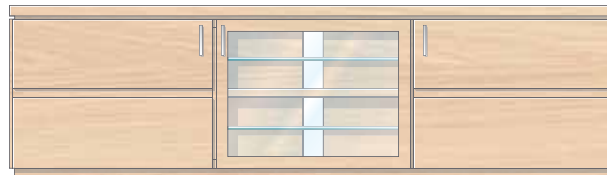

Glazed 3 Door Media Base Unit H322
One central fixed wooden shelf and two removable glass shelves in glazed section.
H510 x W1555 x D430mm
H20 x W61¼ x D17 inches

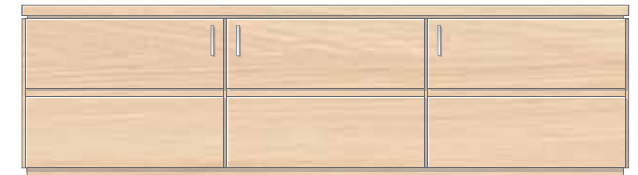

3 Door Base Unit H323
H510 x W1555 x D430mm
H20 x W61¼ x D17 inches



Finish options



Mist
order prefix M

Satin
order prefix S

Chestnut
order prefix C

Dark
order prefix D

To order your chosen finish, please prefix the model code with the appropriate finish prefix.
For example H102 in Mist finish should be ordered as HM102.



Large Wall Shelf H510
H490 x W1200 x D190mm
H19¼ x W47¼ x D7½ inches

Wall Panels For use between Base Units and Wall Units

Height (mm)	Width (mm)	Depth (mm)	Code
470	1035	40	H701
690			H702
930			H703*
470	1555		H704
690			H705
930			H706*

* Features TV cable aperture



Single Open Wall Unit H144
H490 x W520 x D285mm
H19¼ x W20½ x D11¼ inches

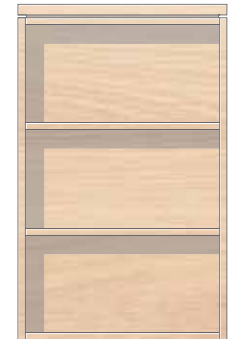

Tall Open Wall Unit H145
H950 x W520 x D285mm
H37½ x W20½ x D11¼ inches



Small Wall Shelf H511
Can be hung either way.
H240 x W895 x D200mm
H9½ x W35¼ x D7¾ inches

Tops for Base Units



Narrow Shelf Unit H601
For 510 height Base Unit.
H1425 x W260 x D285mm
H56 x W10¼ x D11¼ inches

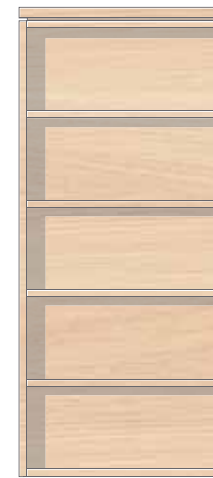

Wide Shelf Unit H151
For 510 height Base Unit.
H1425 x W520 x D285mm
H56 x W20½ x D11¼ inches

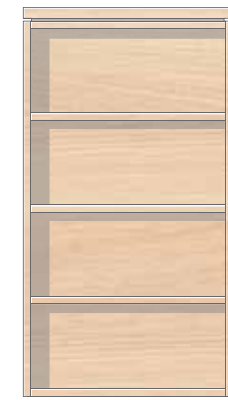

Wide Shelf Unit H152
For 750 height Base Unit.
H1185 x W520 x D285mm
H46¼ x W20½ x D11¼ inches

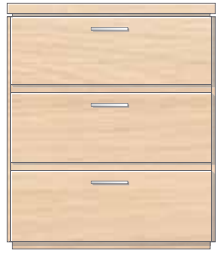

3 Drawer Base Unit H103
H750 x W520 x D430mm
H29½ x W20½ x D17 inches

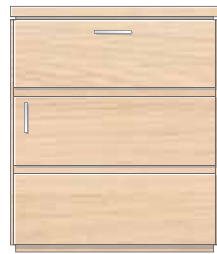

1 Door/1 Drawer Base Unit
H105R Hinged on right (shown)
H105L Hinged on left
H750 x W520 x D430mm
H29½ x W20½ x D17 inches

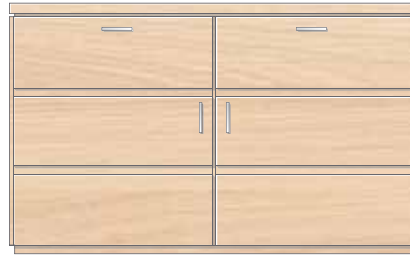

2 Drawer/2 Door Base Unit H215
H750 x W1035 x D430mm
H29½ x W40¾ x D17 inches

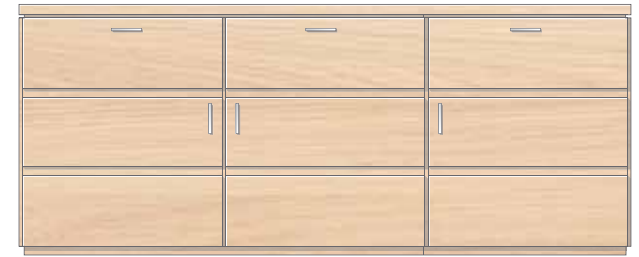

3 Drawer/3 Door Base Unit H324
H750 x W1555 x D430mm
H29½ x W61¼ x D17 inches

Floor Standing Units & Tables

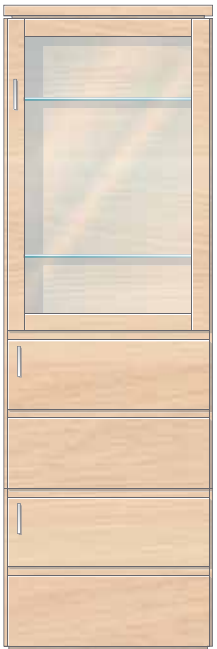

Glazed 3 Door Unit
H107R All doors hinged on right (shown)
H107L All doors hinged on left
Internal light and two adjustable glass shelves
in glazed section.
H1930 x W520 x D430mm
H76 x W20½ x D17 inches



Glazed 2 Door Unit
H108R All doors hinged on right (shown)
H108L All doors hinged on left
Internal light and two adjustable glass shelves
in glazed section.
H1470 x W520 x D430mm
H57¾ x W20½ x D17 inches

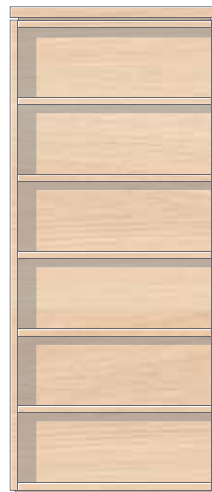

Open Unit H110
H1470 x W520 x D430mm
H57¾ x W20½ x D17 inches



3 Door Unit
H106R All doors hinged on right (shown)
H106L All doors hinged on left
H1470 x W520 x D430mm
H57¾ x W20½ x D17 inches

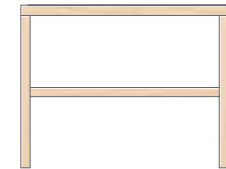

Lamp Table H266
H510 x W520 x D430mm
H20 x W20½ x D17 inches



Coffee Table H265
H375 x W1000 x D600mm
H14¾ x W39¾ x D23½ inches

Sample Configuration

- ① Wide Shelf Unit H151
- ② Double Open Wall Unit H242
- ③ 1 Door Base Unit H104L
- ④ 1 Door Open Media Base Unit H210
- ⑤ 2 Drawer Base Unit H102
- ⑥ Glazed 2 Door Unit H108R



Sample Configuration

- ① Glazed Tall Corner Wall Unit H142L
- ② Glazed 2 Door/1 Shelf Wall Unit H240
- ③ 2 Drawer Base Unit H102
- ④ Open Corner Base Unit H402
- ⑤ 1 Door Base Unit H104R
- ⑥ 4 Drawer Base Unit H213

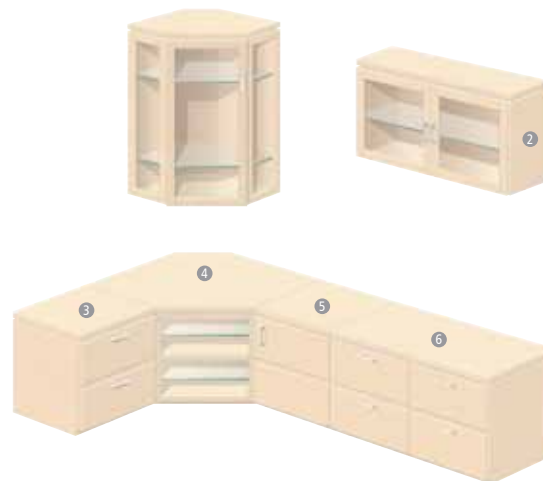

Sample Configuration

- ① Glazed 3 Door Unit H107L
- ② Glazed 2 Door/1 Shelf Wall Unit H240
- ③ Glazed Tall Corner Wall Unit H142R
- ④ 1 Door Open Media Base Unit H210
- ⑤ 2 Drawer Base Unit H102
- ⑥ Open Corner Base Unit H402
- ⑦ 1 Door Base Unit H104R



Sample Configuration

- ① Wide Shelf Unit H151
- ② Narrow Shelf Unit H601
- ③ Double Open Wall Unit H242
- ④ 2 Drawer Base Unit H102
- ⑤ 2 Door Open Media Base Unit H321



Corn dell Furniture Co Ltd.
Witney, Oxfordshire OX29 7DZ

www.corn dell.com

To ensure durability Helix is made from a combination of solid oak and veneered panels. A characteristic of oak are its natural imperfections such as small knots, cracks, blemishes and slight colour variation. These features are a natural part of any real wood product and make each piece of furniture unique.

Care should be taken to avoid extremes of heat and moisture which may adversely affect the wood. As with all wooden furniture there is likely to be some movement while the wood adjusts to its atmospheric conditions.

Our policy is one of continual improvement. We therefore reserve the right to alter designs, dimensions, availability and price without prior notice.

All dimensions in this brochure are believed to be correct at the time of printing, but may subsequently vary, therefore if dimensions are critical please check with your retailer. Imperial measurements are rounded to the nearest quarter or half inch, and metric measurements are rounded to the nearest 5 or 10mm.

Articles used for decoration and styling are not included with the products offered. Colours are as accurate as the printing process allows. All copyright, design rights and other intellectual property rights in our products and designs are and remain the property of Corn dell Furniture Co Ltd.